

STAINLESS STEEL ROLLER CHAINS

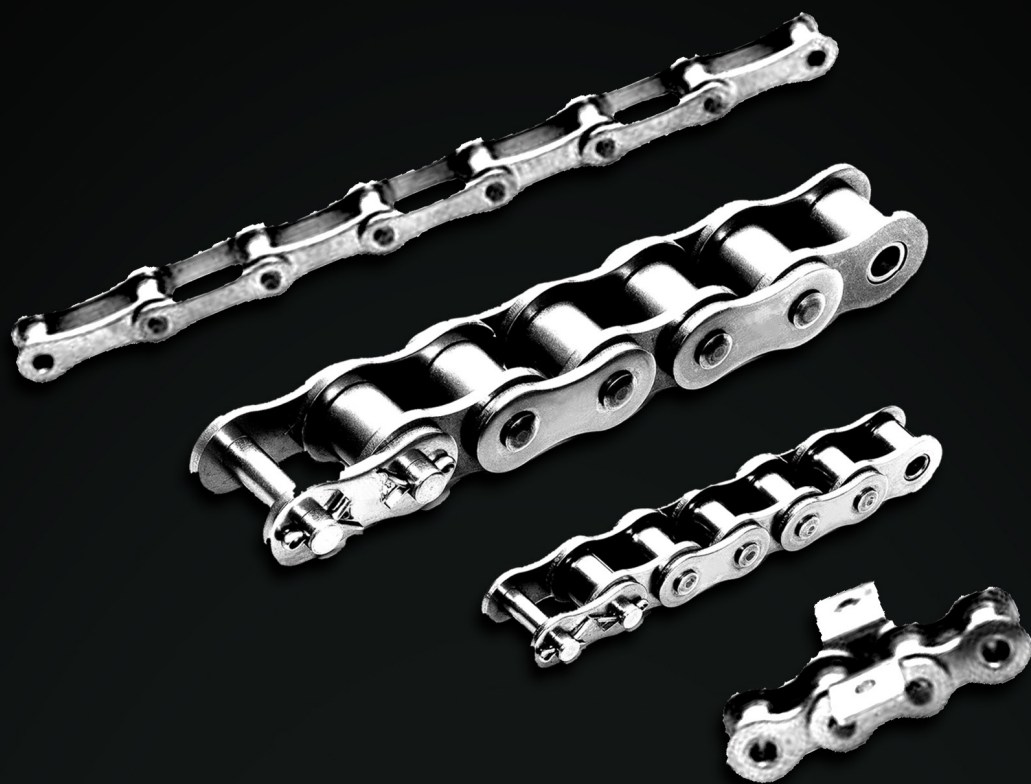

**STAINLESS STEEL
SPECIAL ROLLER CHAINS**

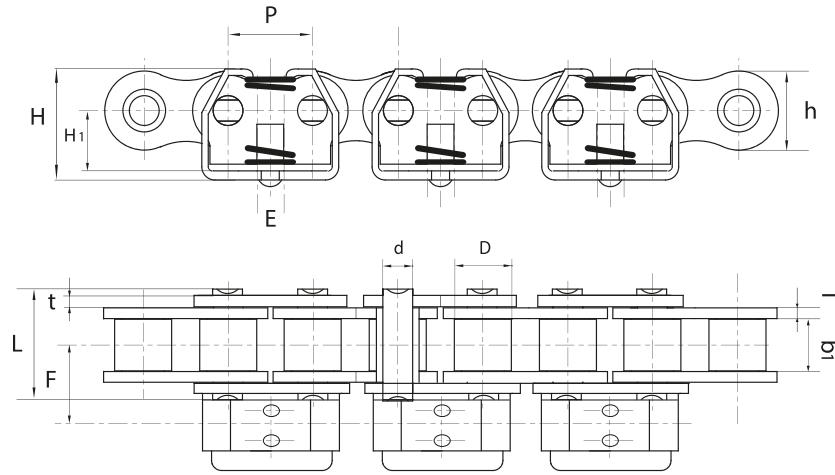

DIN/ISO Chain No.	P mm	b ₁ (min) mm	D (max) mm	d mm	L mm	h mm	H mm	H ₁ mm	E mm	F mm	t/T mm	Q _{min} kN	q kg/m
C08BHOASS	12.7	7.75	8.51	4.45	16.5	11.8	16.3	7.9	20.4	13.9	1.52	10.7	1.13

Q_{min} Kn = Ultimate tensile strenght.

STAINLESS STEEL SPECIAL ROLLER CHAINS

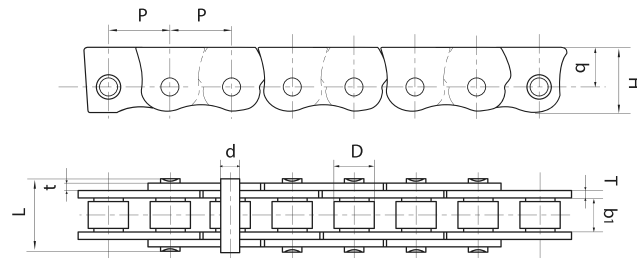

DIN/ISO Chain	P	b ₁ (min)	D (max)	d	L	h	H	t/T	Q _{min}	q
No.	mm	mm	mm	mm	mm	mm	mm	mm	kN	kg/m
C08BSSF15	12.7	7.8	8.51	4.45	16.5	11	16.8	1.52	10	1.02

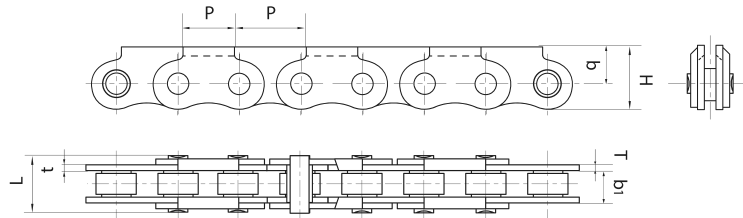

DIN/ISO Chain	P	b ₁ (min)	D (max)	d	L	h	H	t/T	Q _{min}	q
No.	mm	mm	mm	mm	mm	mm	mm	mm	kN	kg/m
08HK	12.7	4.08	7.75	4.09	12.5	8.7	14	1.52	8.2	0.60

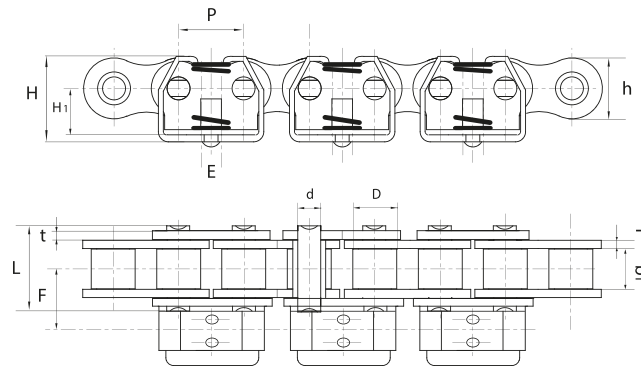

DIN/ISO Chain	P	b ₁ (min)	D (max)	d	L	h	H	H ₁	E	F	t/T	Q _{min}	q
No.	mm	mm	mm	mm	mm	mm	mm	mm	mm	mm	mm	kN	kg/m
C08BHOASS	12.7	7.75	8.51	4.45	16.5	11.8	16.3	7.9	20.4	13.9	1.52	10.7	1.13

Q_{min} Kn = Ultimate tensile strenght.

STAINLESS STEEL SHORT PITCH ROLLER CHAINS-ATTACHMENTS

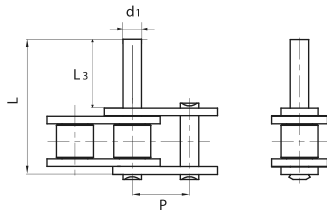

D1

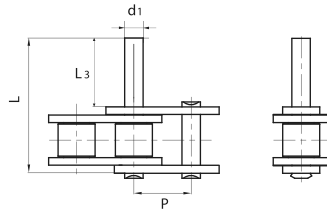

D3

DIN/ISO Chain No.	P mm	L mm	L ₃ mm	d ₁ mm
40SS	12.7	25	9.5	3.96
50SS	15.875	31.2	11.9	5.08
60SS	19.05	38.3	14.3	5.94
80SS	25.4	50.1	19.05	7.92
100SS	31.75	61.5	23.9	9.52
120SS	38.1	76.4	28.6	11.1
08BSS	12.7	28.6	12.7	4.45
10BSS	15.875	29.9	11.9	5.08
12BSS	19.05	35	14.3	5.72
16BSS	25.4	52.8	19.1	8.28

STAINLESS STEEL SPECIAL ROLLER CHAINS

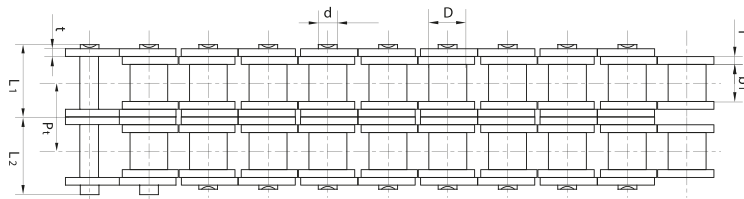
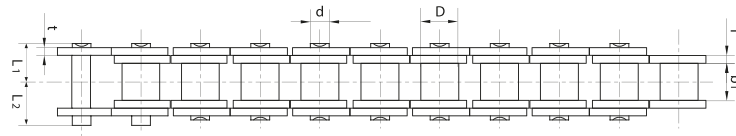
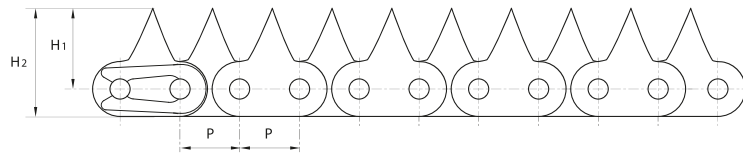

Chain No.	P mm	b ₁ (min) mm	D (max) mm	d mm	L ₁ mm	L ₂ mm	H ₁ mm	H ₂ mm	t/T mm	Pt mm	Q _{min} kN	q kg/m
C40SS-1-N	7.85	7.92	3.96	8.3	9.6	9.6	17.1	22.6	1.52	/	10.4	0.80
C40SS-2-N	7.85	7.92	3.96	16.95	17.95	17.95	17.1	22.6	1.52	14.38	19.76	1.84

Q_{min} Kn = Ultimate tensile strenght.

STAINLESS STEEL SHORT PITCH ROLLER CHAINS-ATTACHMENTS

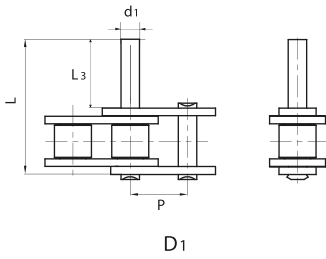

D1

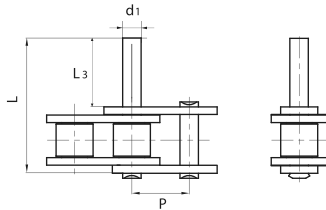

D3

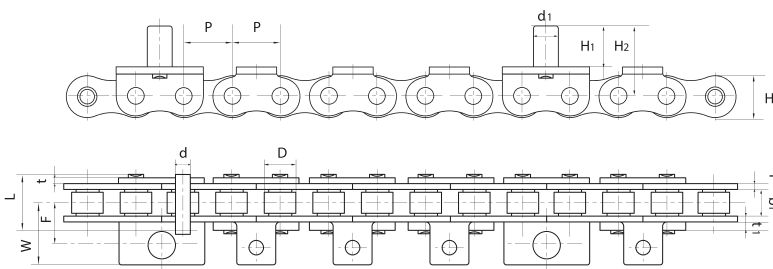

DIN/ISO Chain No.	P mm	L mm	L3 mm	d1 mm
40SS	12.7	25	9.5	3.96
50SS	15.875	31.2	11.9	5.08
60SS	19.05	38.3	14.3	5.94
80SS	25.4	50.1	19.05	7.92
100SS	31.75	61.5	23.9	9.52
120SS	38.1	76.4	28.6	11.1
08BSS	12.7	28.6	12.7	4.45
10BSS	15.875	29.9	11.9	5.08
12BSS	19.05	35	14.3	5.72
16BSS	25.4	52.8	19.1	8.28

Chain No.	P mm	b1 (min) mm	D (max) mm	d mm	L mm	h mm	t/T mm	d1 mm	H1 mm	H2 mm	t1 mm	F mm	W mm	Q _{min} kN	q kg/m
-----------	------	-------------	------------	------	------	------	--------	-------	-------	-------	-------	------	------	---------------------	--------

C50SS-SK1-N4 15.875 9.4 10.16 5.08 21.9 15 2 10 15 26 3 15.5 22.5 19 1.38

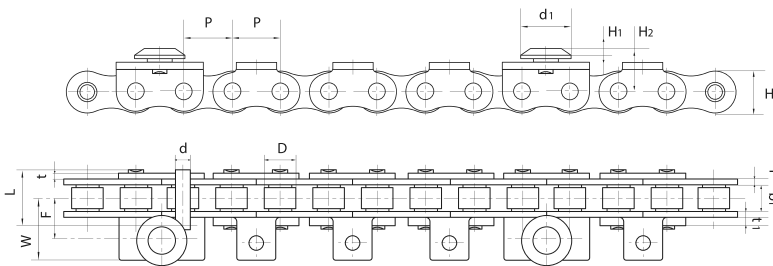

Chain No.	P mm	b1 (min) mm	D (max) mm	d mm	L mm	h mm	t/T mm	d1 mm	H1 mm	H2 mm	t1 mm	F mm	W mm	Q _{min} kN	q kg/m
-----------	------	-------------	------------	------	------	------	--------	-------	-------	-------	-------	------	------	---------------------	--------

C50SS-SK1-N7 15.875 9.4 10.16 5.08 21.9 15 2 18 5.8 16.8 3 15.5 22.5 19 1.38

Q_{min} Kn = Ultimate tensile strenght.

STAINLESS STEEL SHORT PITCH ROLLER CHAINS-ATTACHMENTS

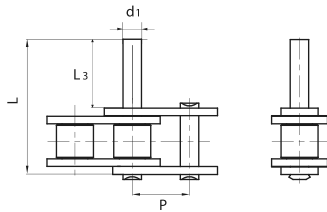

D1

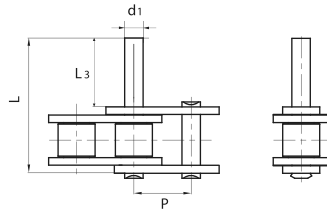

D3

DIN/ISO Chain No.	P mm	L mm	L ₃ mm	d ₁ mm
40SS	12.7	25	9.5	3.96
50SS	15.875	31.2	11.9	5.08
60SS	19.05	38.3	14.3	5.94
80SS	25.4	50.1	19.05	7.92
100SS	31.75	61.5	23.9	9.52
120SS	38.1	76.4	28.6	11.1
08BSS	12.7	28.6	12.7	4.45
10BSS	15.875	29.9	11.9	5.08
12BSS	19.05	35	14.3	5.72
16BSS	25.4	52.8	19.1	8.28

STAINLESS STEEL SPECIAL ROLLER CHAINS

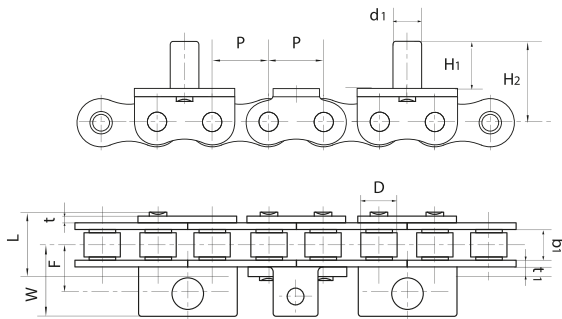

C50SS-SK1-N4

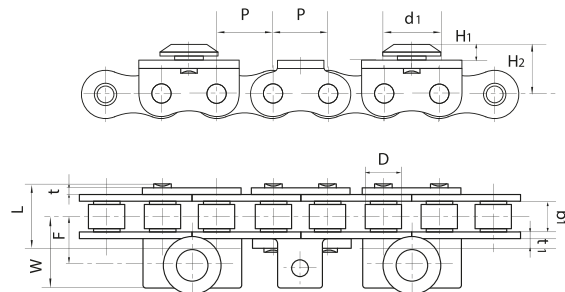

C50SS-SK1-N7

Chain No.	P mm	b ₁ (min) mm	D (max) mm	L mm	d ₁ mm	H ₁ mm	H ₂ mm	t ₁ mm	F mm	W mm	Q _{min} kN	q kg/m
C50SS-SK1-N4	15.875	15.875	10.16	21.9	10	15	26	3	15.5	22.5	19	1.38
C50SS-SK1-N7	15.875	15.875	10.16	21.9	18	5.8	16.8	3	15.5	22.5	19	1.38

Q_{min} Kn = Ultimate tensile strenght.

STAINLESS STEEL SHORT PITCH ROLLER CHAINS-ATTACHMENTS

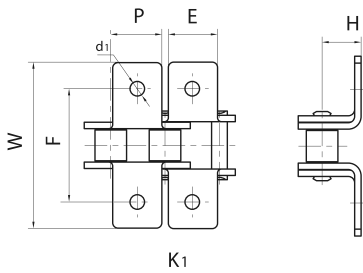
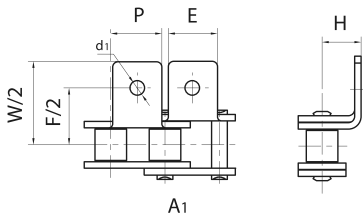

DIN/ISO Chain No.	P mm	W mm	F mm	E mm	d1 mm	H mm
35SS	9.525	27	19.05	7.94	2.78	6.35
40SS	12.7	34	25.4	9.5	3.6	7.9
50SS	15.875	47.75	31.75	14	5.3	10.3
60SS	19.05	54.8	38.1	15.9	5.2	11.9
80SS	25.4	71.4	50.8	22.2	6.8	15.9
100SS	31.75	84.1	63.5	25.4	8.33	19.84
120SS	38.1	104.8	76.2	28.6	11	23
06BSS	9.525	27	19.05	7.94	3.25	6.35
08BSS	12.7	35.6	25.4	12	4.5	8.9
10BSS	15.875	44.6	31.75	14.3	5.3	10.31
12BSS	19.05	52.3	38.1	15.9	6.4	13.46
16BSS	25.4	72.6	50.8	19.1	6.4	15.88

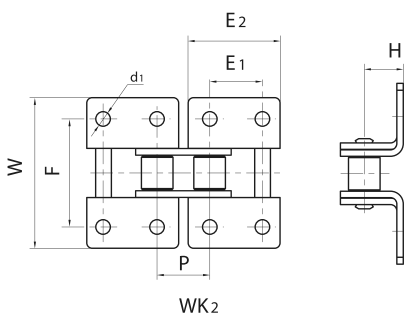
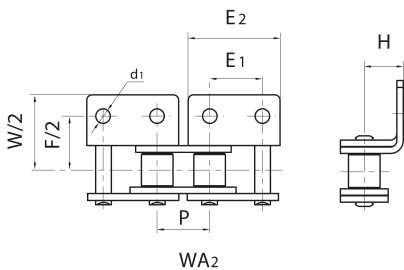

DIN/ISO Chain No.	P mm	W mm	F mm	E1 mm	E2 mm	d1 mm	H mm
40SS	12.7	34	25.4	12.7	23.1	3.6	7.9
50SS	15.875	48.15	31.75	15.875	28.78	5.5	10.3
60SS	19.05	54.8	38.1	19.05	34.59	5.5	11.9
80SS	25.4	71.4	50.8	25.4	45.9	6.6	15.9
100SS	31.75	84.1	63.5	31.75	57.75	9.3	19.84
120SS	38.1	104.8	76.2	38.1	69.1	11	23
08BSS	12.7	35.6	25.4	12.7	23.6	4.5	8.9
10BSS	15.875	44.6	31.75	15.875	29.48	5.3	10.31
12BSS	19.05	52.3	38.1	19.05	35.05	6.4	13.46
16BSS	25.4	72.6	50.8	25.4	46.3	6.4	15.88

STAINLESS STEEL DOUBLE PITCH ROLLER CHAINS-ATTACHMENTS

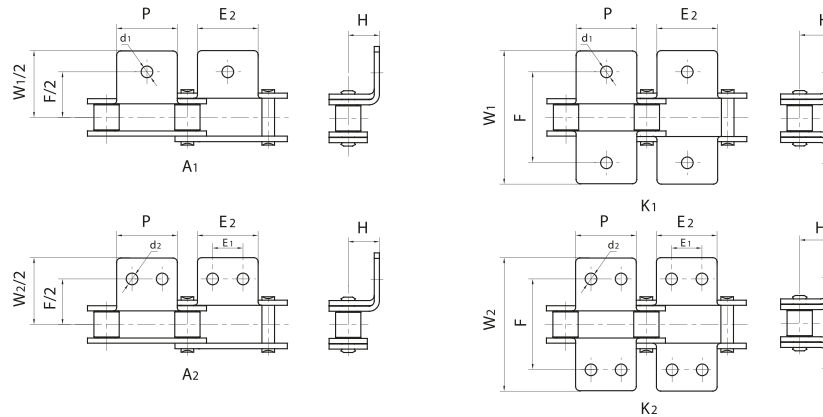

ANSI Chain No.	P mm	W ₁ mm	W ₂ mm	F mm	E ₁ mm	E ₂ mm	d ₁ mm	d ₂ mm	H mm
C2040SS	25.4	39.6	39.6	25.4	9.5	19.1	3.6	3.6	9.1
C2042SS									
C2040HSS									
C2042HSS									
25.4	39.6	39.6	25.4	9.5	19.1	3.6	3.6	9.1	
C208BSS	25.4	39.6	38.6	25.4	12.7	24	4.5	4.5	9.1
C208BLSS									
C2050SS	31.75	48.4	48.4	31.8	11.9	24	5.5	5.2	11.1
C2052SS									
C2050HSS	31.75	48.4	48.4	31.8	11.9	24	5.5	5.2	11.1
C2052HSS									
C2060SS	38.1	61.06	61.06	42.86	14.3	28.6	5.2	5.2	14.7
C2062SS									
C2060HSS	38.1	61.06	61.06	42.86	14.3	28.6	5.5	5.2	14.7
C2062HSS									
C2080SS	50.8	76.2	76.2	55.6	19.1	38.1	6.8	6.8	19.1
C2082SS									
C2080HSS	50.8	79.4	79.4	55.6	19.1	38.1	6.8	6.8	19.1
C2082HSS									
C2100SS	63.5	98	98	66.6	23.8	47.5	8.8	9.5	23.4
C2102SS									
C2100HSS	63.5	98	98	66.6	23.8	47.5	8.8	9.5	23.4
C2102HSS									
C2120SS	76.2	118.3	118.3	79.3	28.6	57.1	11	11	27.8
C2122SS									
C2120HSS	76.2	118.3	118.3	79.3	28.6	57.1	11	11	27.8
C2122HSS									

STAINLESS STEEL DOUBLE PITCH ROLLER CHAINS-ATTACHMENTS

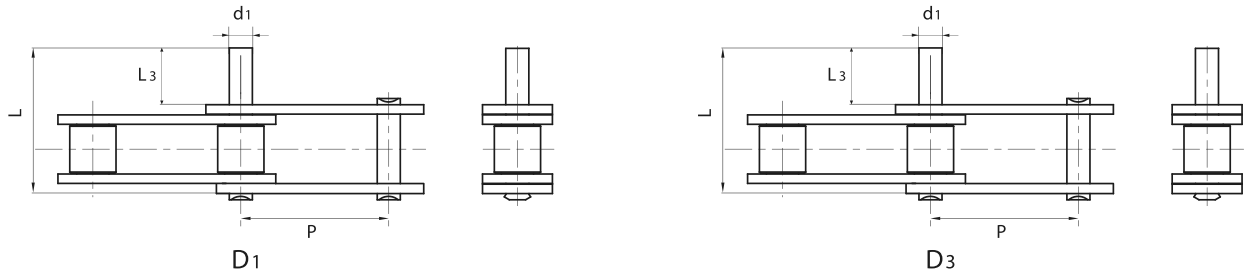

ANSI Chain No.	P mm	L mm	L ₃ mm	d ₁ mm
C2040SS	25.4	25	9.5	3.96
C2042SS				
C2040HSS				
C2042HSS				
25.4	26.9	9.5	3.96	
C208BSS	25.4	28.6	12.7	4.45
C208BLSS				
C2050SS	31.75	31.2	11.9	5.08
C2052SS				
C2050HSS	31.75	32.8	11.9	5.08
C2052HSS				
C2060SS	38.1	38.3	14.3	5.94
C2062SS				
C2060HSS	38.1	41.6	14.3	5.94
C2062HSS				
C2080SS	50.8	50.2	19.1	7.92
C2082SS				
C2080HSS	50.8	53.2	19.1	7.92
C2082HSS				
C2100SS	63.5	61.5	23.8	9.52
C2102SS				
C2100HSS	63.5	65	23.8	9.52
C2102HSS				
C2120SS	76.2	76.4	28.6	11.1
C2122SS				
C2120HSS	76.2	79.4	28.6	11.1
C2122HSS				
C2160SS	101.6	99.3	38.1	14.27
C2162SS				
C2160HSS	101.6	102.7	38.1	14.27
C2162HSS				

STAINLESS STEEL DOUBLE PITCH ROLLER CHAINS-ATTACHMENTS

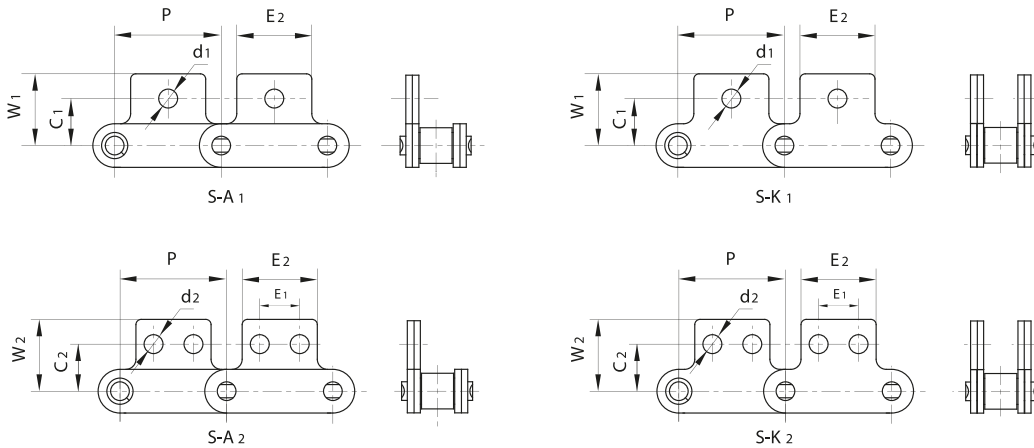

ANSI Chain No.	P mm	W ₁ mm	W ₂ mm	C ₁ mm	C ₂ mm	E ₁ mm	E ₂ mm	d ₁ mm	d ₂ mm
C2040SS	25.4	19.4	19.4	11.1	13.5	9.5	19	3.6	3.6
C2042SS									
C2040HSS									
C2042HSS									
25.4	39.6	19.4	11.1	13.5	9.5	19	3.6	3.6	
C208BSS	25.4	19.8	19.8	11.1	13.2	12.7	24	4.5	4.5
C208BLSS									
C2050SS	31.75	24.6	25	14.3	15.9	11.9	23.8	6.35	5.2
C2052SS									
C2050HSS	31.75	24.6	25	14.3	15.9	11.9	23.8	6.35	5.2
C2052HSS									
C2060SS	38.1	30.1	29.8	17.5	19.05	14.3	28.6	8.33	5.2
C2062SS									
C2060HSS	38.1	30.1	29.8	17.5	19.05	14.3	28.6	8.33	5.2
C2062HSS									
C2080SS	50.8	37.4	37.4	22.2	25.5	19.05	38.1	11.0	6.8
C2082SS									
C2080HSS	50.8	37.4	37.4	22.2	25.5	19.05	38.1	11.0	6.8
C2082HSS									
C2100SS	63.5	47.8	47.8	28.6	31.8	23.8	47.5	13.1	8.2
C2102SS									
C2100HSS	63.5	47.8	47.8	28.6	31.8	23.8	47.5	13.1	8.2
C2102HSS									
C2120SS	76.2	63	63	33.3	37.3	28.6	57	15.0	10.5
C2122SS									
C2120HSS	76.2	63	63	33.3	37.3	28.6	57	15.0	10.5
C2122HSS									

STAINLESS STEEL CONVEYOR DOUBLE PITCH ROLLER CHAINS

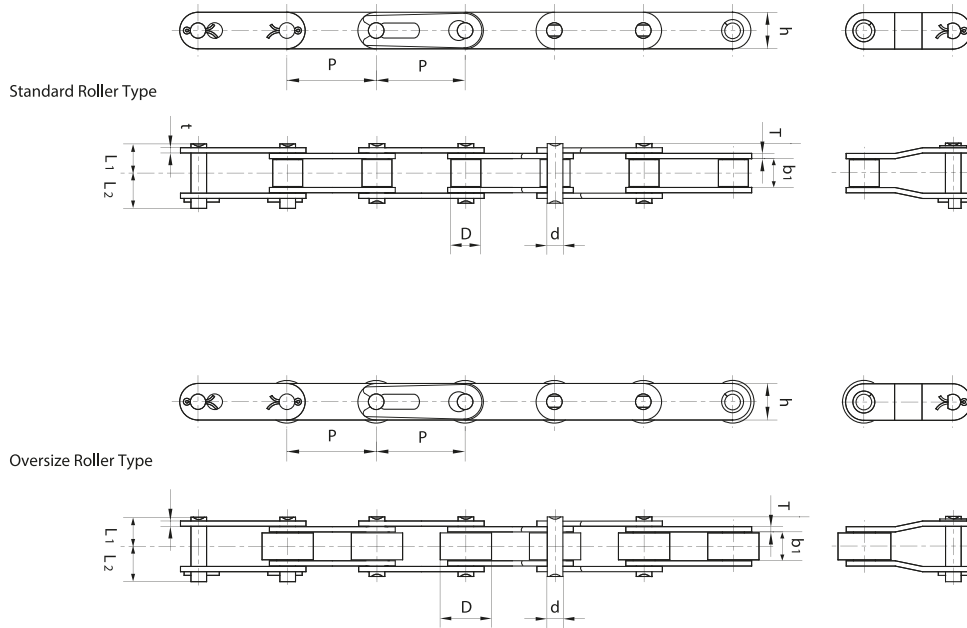

ANSI Chain No.	P mm	b ₁ (min) mm	D (max) mm	d mm	L ₁ mm	L ₂ mm	h mm	t/T mm	Q _{min} kN	q kg/m
C2040HSS	25.4	7.85	7.92	3.96	9.25	10.55	12	2	10.4	0.63
C2042HSS	25.4	7.85	15.88	3.96	9.25	10.55	12	2	10.4	0.97
C2050HSS	31.75	9.4	10.16	5.08	11.05	12.45	15	2.4	19	0.95
C2052HSS	31.75	9.4	19.05	5.08	11.05	12.45	15	2.4	19	1.41
C2060HSS	38.1	12.57	11.91	5.94	14.3	15.7	18	3.2	24	1.51
C2062HSS	38.1	12.57	22.23	5.94	14.3	15.7	18	3.2	24	2.20
C2080HSS	50.8	15.75	15.88	7.92	17.85	19.25	23.5	4	42.8	2.20
C2082HSS	50.8	15.75	28.58	7.92	17.85	19.25	23.5	4	42.8	3.52
C2100HSS	63.5	18.9	19.05	9.52	21.55	25.05	30	4.9	58	3.77
C2102HSS	63.5	18.9	39.67	9.52	21.55	25.05	30	4.9	58	5.89
C2120HSS	76.2	25.22	22.23	11.1	26.5	20.9	35.8	5.6	78	5.29
C2122HSS	76.2	25.22	44.45	11.1	26.5	20.9	35.8	5.6	78	8.22

Q_{min} Kn = Ultimate tensile strenght.

Connecting Type:

The series less than C2060HSS (including C2060HSS) is preferred for spring clip type;

The series larger than C2080HSS (including C2080HSS) is preferred for cottered type.

STAINLESS STEEL CONVEYOR DOUBLE PITCH ROLLER CHAINS

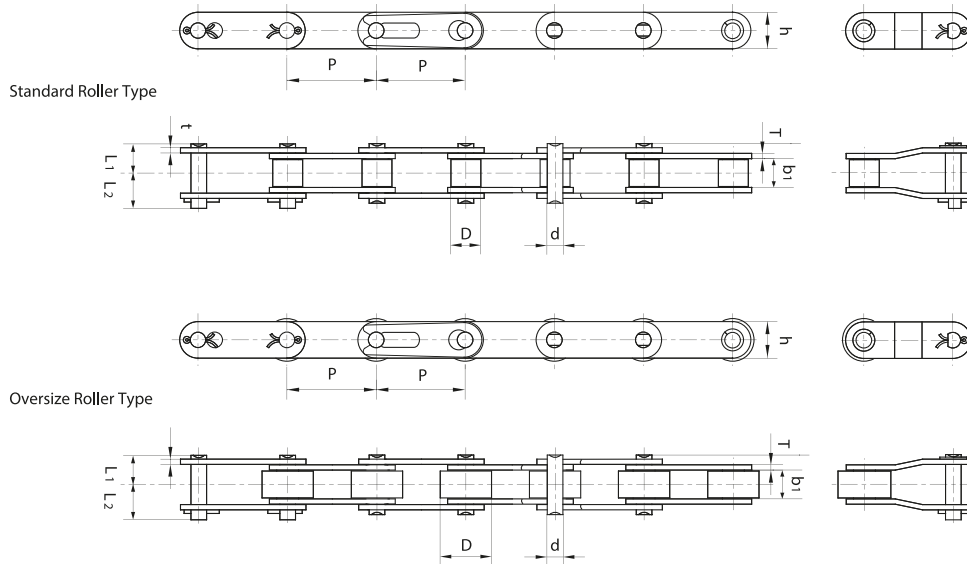

ANSI Chain	P	b ₁ (min)	D (max)	d	L ₁	L ₂	h	t/T	Q _{min}	q
No.	mm	mm	mm	mm	mm	mm	mm	mm	kN	kg/m
C2040SS	25.4	7.85	7.92	3.96	8.3	9.6	12	1.52	10.4	0.52
C2042SS	25.4	7.85	15.88	3.96	8.3	9.6	12	1.52	10.4	0.86
C208BSS	25.4	7.75	8.51	4.45	8.5	9.9	11.8	1.65	11.3	0.56
C208BLSS	25.4	7.75	15.88	4.45	8.5	9.9	11.8	1.65	11.3	0.88
C2050SS	31.75	9.4	10.16	5.08	10.25	11.85	15	2	19	0.83
C2052SS	31.75	9.4	19.05	5.08	10.25	11.85	15	2	19	1.29
C2060SS	38.1	12.57	11.91	5.94	12.65	14.35	18	2.4	24	1.20
C2062SS	38.1	12.57	22.23	5.94	12.65	14.35	18	2.4	24	1.91
C2080SS	50.8	15.75	15.88	7.92	16.2	17.9	23.5	3.2	42.8	2.10
C2082SS	50.8	15.75	28.58	7.92	16.2	17.9	23.5	3.2	42.8	3.12
C2100SS	63.5	18.9	19.05	9.52	19.8	23.3	30	4	58	3.22
C2102SS	63.5	18.9	39.67	9.52	19.8	23.3	30	4	58	5.33
C2120SS	76.2	25.22	22.23	11.1	25	28.3	35.8	4.9	78	4.72
C2122SS	76.2	25.22	44.45	11.1	25	28.3	35.8	4.9	78	7.72

Q_{min} Kn = Ultimate tensile strenght.

Connecting Type:

The series less than C2060SS (including C2060SS) is preferred for spring clip type;

The series larger than C2080SS (including C2080SS) is preferred for cottered type.

STAINLESS STEEL SHORT PITCH ROLLER CHAINS-ATTACHMENTS

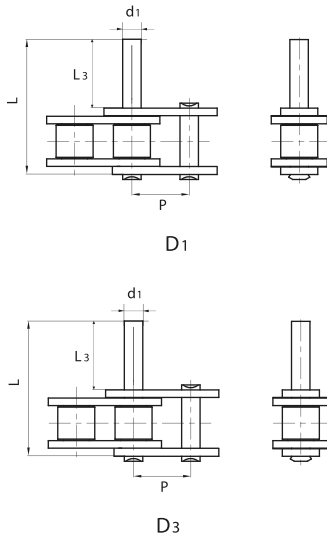

DIN/ISO Chain No.	P mm	L mm	L ₃ mm	d ₁ mm
40SS	12.7	25	9.5	3.96
50SS	15.875	31.2	11.9	5.08
60SS	19.05	38.3	14.3	5.94
80SS	25.4	50.1	19.05	7.92
100SS	31.75	61.5	23.9	9.52
120SS	38.1	76.4	28.6	11.1
08BSS	12.7	28.6	12.7	4.45
10BSS	15.875	29.9	11.9	5.08
12BSS	19.05	35	14.3	5.72
16BSS	25.4	52.8	19.1	8.28

STAINLESS STEEL TRANSMISSION DOUBLE ROLLER CHAINS

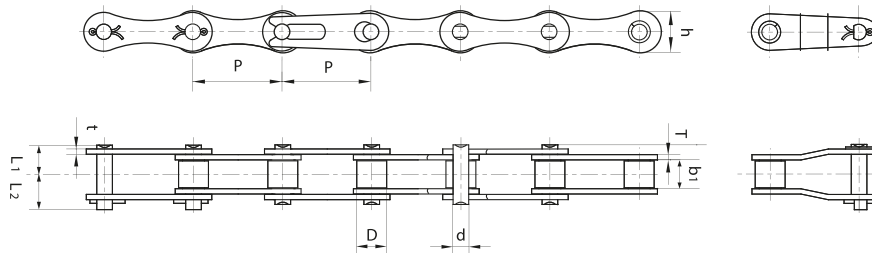

ANSI Chain No.	P mm	b ₁ (min) mm	D (max) mm	d mm	L ₁ mm	L ₂ mm	h mm	t/T mm	Q _{min} kN	q kg/m
C2040HSS	25.4	7.85	7.92	3.96	8.3	9.6	12	1.52	10.4	0.42
C2050HSS	31.75	9.4	10.16	5.08	10.25	11.85	15	2	19	0.69
C2060HSS	38.1	12.57	11.91	5.94	12.65	14.35	18	2.4	24	1.01
C2080HSS	50.8	15.75	15.88	7.92	16.2	17.9	23.5	3.2	42.8	1.74

Q_{min} Kn = Ultimate tensile strenght.

Connecting Type:

The series less than C2060SS (including C2060SS) is preferred for spring clip type;

The series larger than C2080SS (including C2080SS) is preferred for cottered type.

A, B SERIES STAINLESS STEEL SHORT PITCH ROLLER CHAINS-ATTACHMENTS

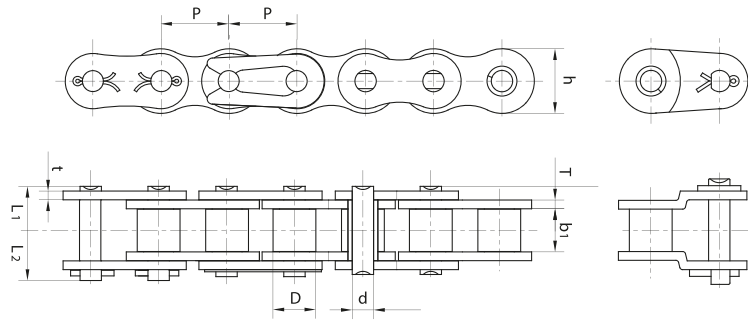

DIN/ISO Chain	P	b ₁ (min)	D (max)	d	L ₁	L ₂	h	t/T	Q _{min}	q
No.	mm	mm	mm	mm	mm	mm	mm	mm	kN	kg/m
*25SS-1	6.35	3.1	3.3	2.31	3.9	4.8	5.9	0.75	2.34	0.14
*35SS-1	9.525	4.68	5.08	3.58	6	7.2	9	1.27	6	0.35
41SS-1	12.7	6.25	7.77	3.58	6.85	8.25	9.8	1.27	4.7	0.44
40SS-1	12.7	7.85	7.92	3.96	8.3	9.6	12	1.52	10.4	0.65
50SS-1	15.875	9.4	10.16	5.08	10.25	11.85	15	2	19	1.04
60SS-1	19.05	12.57	11.91	5.94	12.65	14.35	18	2.4	24	1.54
80SS-1	25.4	15.75	15.88	7.92	16.35	17.75	23.5	3.2	42.8	2.64
100SS-1	31.75	18.9	19.05	9.52	19.8	23.3	30	4	58	3.98
120SS-1	38.1	25.22	22.23	11.1	25	28.3	35.8	4.9	78	5.87
03BSS-1	5	2.5	3.2	1.49	3.1	4.1	4.1	0.6	1.3	0.09
04BSS-1	6	2.8	4	1.85	3.3	4.2	5	0.6	1.3	0.12
05BSS-1	8	3	5	2.31	3.9	4.8	7	0.75	3.5	0.18
06BSS-1	9.525	5.72	6.35	3.28	6.27	7.23	8.2	1.0/1.27	5.4	0.38
08BSS-1	12.7	7.75	8.51	4.45	8.5	9.9	11.8	1.65	11.3	0.74
10BSS-1	15.875	9.65	10.16	5.08	9.6	10.9	14.6	1.65	14.9	0.95
12BSS-1	19.05	11.68	12.07	5.72	11	12.4	16	1.8	17.5	1.22
16BSS-1	25.4	17.02	15.88	8.28	17.65	19.05	20.9	3.2/4	42	2.77
20BSS-1	31.75	19.56	19.05	10.19	20.2	23.8	26	3.6/4.5	60	3.84
24BSS-1	38.1	25.4	25.4	14.63	26.65	31.05	33	5/6	92.8	7.04

Q_{min} Kn = Ultimate tensile strenght.

* Chains: Bushing chains with no roller;

Connecting Type:

The series less than 80SS, 16BSS (including 80SS, 16BSS) is preferred for spring clip type;

The series larger than 100SS, 20BSS (including 100SS, 20BSS) is preferred for cottered type.

A, B SERIES STAINLESS STEEL SHORT PITCH ROLLER CHAINS

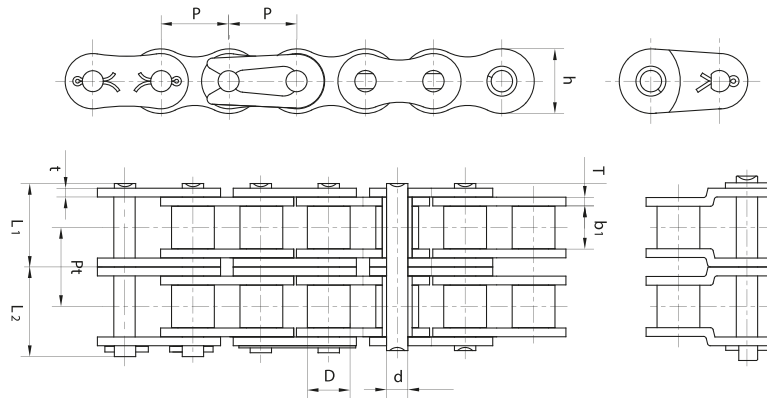

DIN/ISO Chain	P	b ₁ (min)	D (max)	d	L ₁	L ₂	H	t/T	Pt	Q _{min}	q
No.	mm	mm	mm	mm	mm	mm	mm	mm	mm	kN	kg/m
*25SS-2	6.35	3.1	3.3	2.31	7.1	7.9	5.9	0.75	6.4	4.45	0.27
*35SS-2	9.525	4.68	5.08	3.58	11.1	12.3	9	1.27	10.13	11.4	0.69
40SS-2	12.7	7.85	7.92	3.96	15.5	16.7	12	1.52	14.38	19.76	1.30
50SS-2	15.875	9.4	10.16	5.08	19.3	20.7	15	2	18.11	36.1	2.06
60SS-2	19.05	12.57	11.91	5.94	24.05	25.95	18	2.4	22.78	45.6	3.06
80SS-2	25.4	15.75	15.88	7.92	31	32.4	23.5	3.2	29.29	81.32	5.26
100SS-2	31.75	18.9	19.05	9.52	37.7	41.1	30	4	35.76	110.2	7.90
120SS-2	38.1	25.22	22.23	11.1	47.75	51.05	35.8	4.9	45.44	148.2	11.68
05BSS-2	8	3	5	2.31	6.75	7.59	7	0.75	5.64	6.65	0.36
06BSS-2	9.525	5.72	6.35	3.28	11.4	12.4	8.2	1.0/1.27	10.24	10.26	0.74
08BSS-2	12.7	7.75	8.51	4.45	15.5	16.9	11.8	1.65	13.92	21.47	1.45
10BSS-2	15.875	9.65	10.16	5.08	17.9	19.3	14.6	1.65	16.59	28.31	1.88
12BSS-2	19.05	11.68	12.07	5.72	20.75	22.15	16	1.8	19.46	33.25	2.42
16BSS-2	25.4	17.02	15.88	8.28	33.6	35	20.9	3.2/4	21.88	79.8	5.47
20BSS-2	31.75	19.56	19.05	10.19	38.45	42.05	26	3.6/4.5	36.45	114	7.61
24BSS-2	38.1	25.4	25.4	14.63	50.85	55.25	33	5/6	48.36	176.3	13.91

Q_{min} Kn = Ultimate tensile strenght.

* Chains: Bushing chains with no roller;

Connecting Type:

The series less than 80SS, 16BSS (including 80SS, 16BSS) is preferred for spring clip type;

The series larger than 100SS, 20BSS (including 100SS, 20BSS) is preferred for cottered type.